



**MICROPRECISION ELECTRONICS SA**

P.O. Box 160 ▪ Route de l'Industrie 27  
CH - 1896 VOUVRY ▪ SWITZERLAND  
Tel: +41(0)24 481 43 43 ▪ Fax: +41(0)24 481 43 60  
info@microprecision.ch ▪ www.microprecision.ch



**SERIES  
MP500**

**NEW  
IMPROVED  
VERSION**

- PCB terminals, solder terminals or PVC cable
- IP 67 Protection
- Silver or gold plated contacts
- Wide choice of actuators
- V4 housing
- Reduced differential movement

**Trust more than 50 years of experience!**

Companies, whose activities encompass such different areas as food processing, chemicals, machine-tools, transport, etc., have been placing their trust in Microprecision Electronics SA for a long time; they have found it to be a first-class and reliable partner, able to supply tailor-made products which meet international standards.

56 basic types and more than 1000 possible configurations allow virtually any application to be met in industries where harsh environments require the highest technological competence.

Microprecision Electronics SA has set itself the task of listening to its customers expectations so that it can provide tailor-made solutions for small production runs.

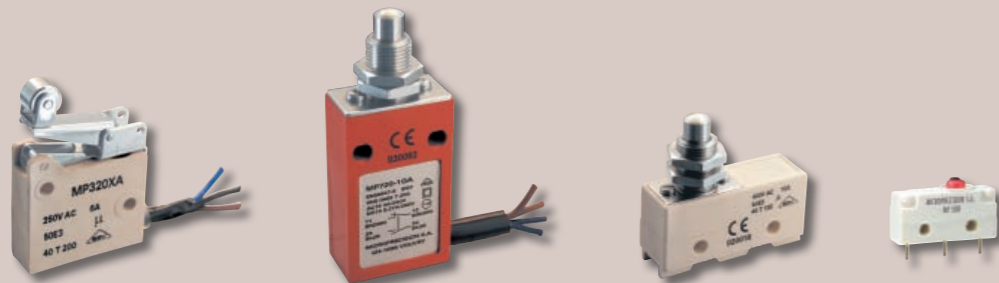

Microswitches and sealed position switches

**If your application depends on it**



For more information, please contact one of our resellers or visit our website: [www.microprecision.ch](http://www.microprecision.ch)



## Operating Characteristics

|  | L00      | L70       | L71       | L80       | L81       | L85       | L86       |
|--|----------|-----------|-----------|-----------|-----------|-----------|-----------|
| <b>Actuating force</b><br><b>Fa max [N]</b>    | 2.5      | 1.0       | 2.0       | 1.0       | 2.0       | 1.0       | 2.0       |
| <b>Release force</b><br><b>Fr min [N]</b>      | 0.5      | 0.15      | 0.3       | 0.15      | 0.3       | 0.15      | 0.3       |
| <b>Free position</b><br><b>Pr [mm]</b>         | 9.2 ±0.2 | 12.0 ±0.4 | 10.3 ±0.4 | 17.3 ±0.4 | 15.9 ±0.4 | 15.0 ±0.4 | 13.5 ±0.4 |
| <b>Operating position</b><br><b>Pa [mm]</b>    | 8.7 ±0.2 | 10.0 ±0.4 | 9.4 ±0.4  | 15.3 ±0.4 | 15.0 ±0.4 | 13.0 ±0.4 | 12.6 ±0.4 |
| <b>Repetitivity</b><br><b>[mm]</b>             | ±0.02    | ±0.04     | ±0.04     | ±0.04     | ±0.04     | ±0.04     | ±0.04     |
| <b>Over-travel</b><br><b>sr min [mm]</b>       | 0.6      | 1.2       | 0.6       | 1.2       | 0.6       | 1.2       | 0.6       |
| <b>Differential</b><br><b>movement sd [mm]</b> | 0.05     | 0.4       | 0.3       | 0.4       | 0.3       | 0.4       | 0.3       |
| <b>Contact</b><br><b>gap [mm]</b>              | 0.4      | 0.4       | 0.4       | 0.4       | 0.4       | 0.4       | 0.4       |

## Electrical characteristics

### Switching rating

- contact silver: 250VAC - 2A - changeover
- gold plated on silver: 24VAC/DC - 0.1A

## Approved Standard : EN61058

## Other characteristics

|                              |   |
|------------------------------|---|
| <b>Mechanism</b>             | Snap action coil spring mechanism with stainless steel spring |
| <b>Circuit</b>               | SPDT changeover   |
| <b>Mechanical lifespan</b>   | 10x10 <sup>6</sup> cycles                                     |
| <b>Dimensions</b>            | DIN 41 635, B-form  |
| <b>Actuators</b>             | Stainless steel   |
| <b>Operating temperature</b> | -40°C to 100°C  |
| <b>Protection</b>            | IP67  |

Products and Specifications are subject to change without notice.

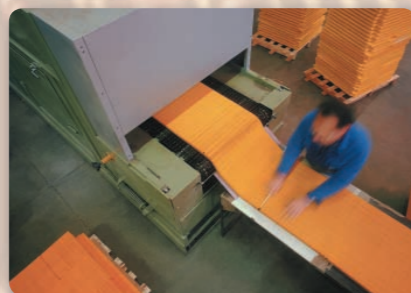
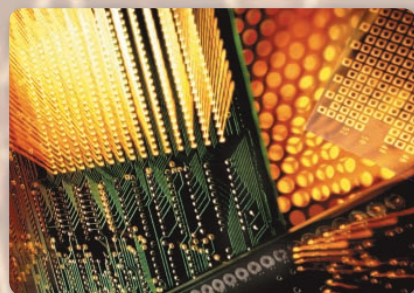

## Ordering Reference

MP50   - L     - C      

- CONTACT**  
**0** Silver contact  
**1** Gold-plated contact

- LEVER**  
**00** Without lever  
**70** Flat- position A  
**71** Flat- position B  
**80** Roller- position A  
**81** Roller- position B  
**85** Simulated roller- position A  
**86** Simulated roller- position B

- TERMINALS**  
**000** Solder terminals -40°C + 100°C / -40°F + 212°F  
**001** PCB -40°C + 100°C / -40°F + 212°F  
**100** 50 cm PVC cable -40°C + 100°C / -40°F + 212°F  
*Other lengths on request*

**PVC**  
**MP500 - L - C100**

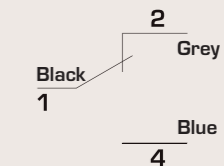

**CS**  
**MP500 - L - C000**

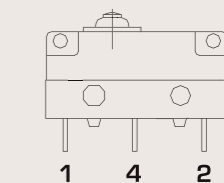

**PCB**  
**MP500 - L - C001**

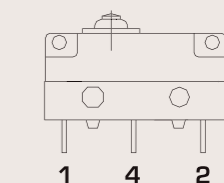

**Layout PCB**



## Examples of terminals

**MP500 - L00 - C000**

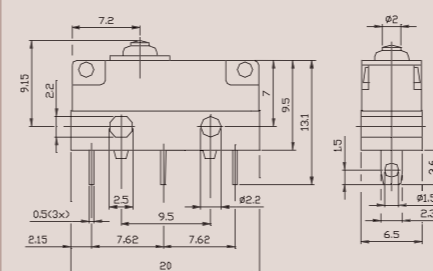

**MP500 - L00 - C100**

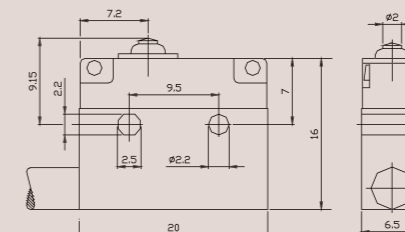

**MP500 - L00 - C001**

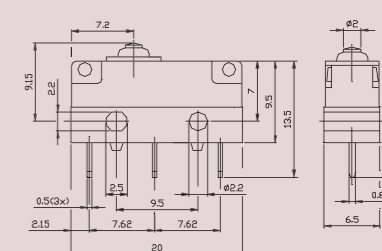

## Examples of levers (L)

**MP500 - L70**

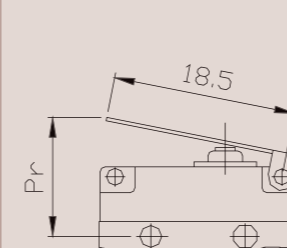

**MP500 - L80**

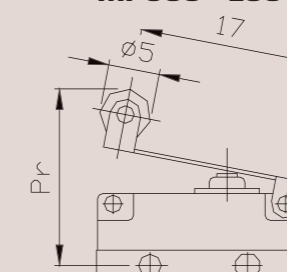

**MP500 - L85**

